

FX25 CSF COUNTERSUNK PIN

25mm DIAMETER COUNTERSUNK SCREW FIXING

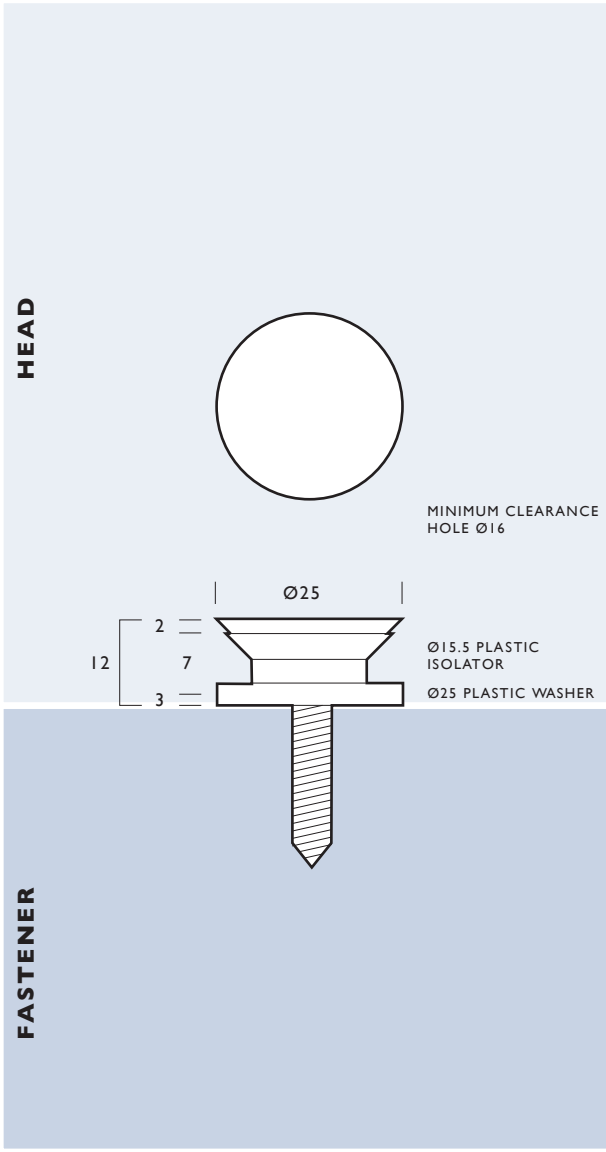

HEAD:

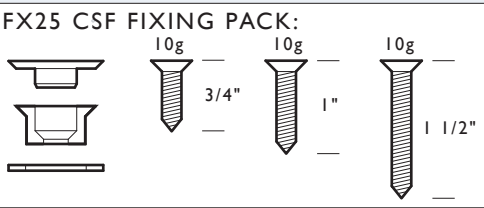
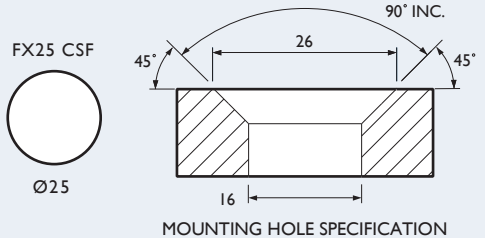

BODY:

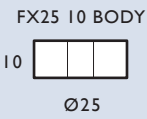

FASTENER:

- please nominate required screw length*
 - 1/4" B.S.W COUNTERSUNK MACHINE SCREWS
 - 10g SELF DRILLING SCREWS
 - 10g SELF TAPPING SCREWS
- *VARIOUS LENGTHS AVAILABLE

MATERIAL:

316 Grade Stainless Steel

PANEL THICKNESS:

Head Pack 6 - 12mm
Can be used with 10g countersunk self tapping, self drilling or machine screw

MINIMUM CLEARANCE HOLE:

The clearance hole is 16mm, which is then countersunk to 26mm (refer to diagram).

SCREW:

10g countersunk screw

FINISH:

Satin Stainless Steel

LOCATION:

Interior and exterior applications

PRODUCT COMPLIANCY:

As FIX Systems are not certified engineers, it is the buyer's responsibility to ensure that the application of all FIX products is suitable for its intended use and that it is compliant with relevant safety standards.

