

FX32 CSP COUNTERSUNK PIN

32mm DIAMETER COUNTERSUNK PIN

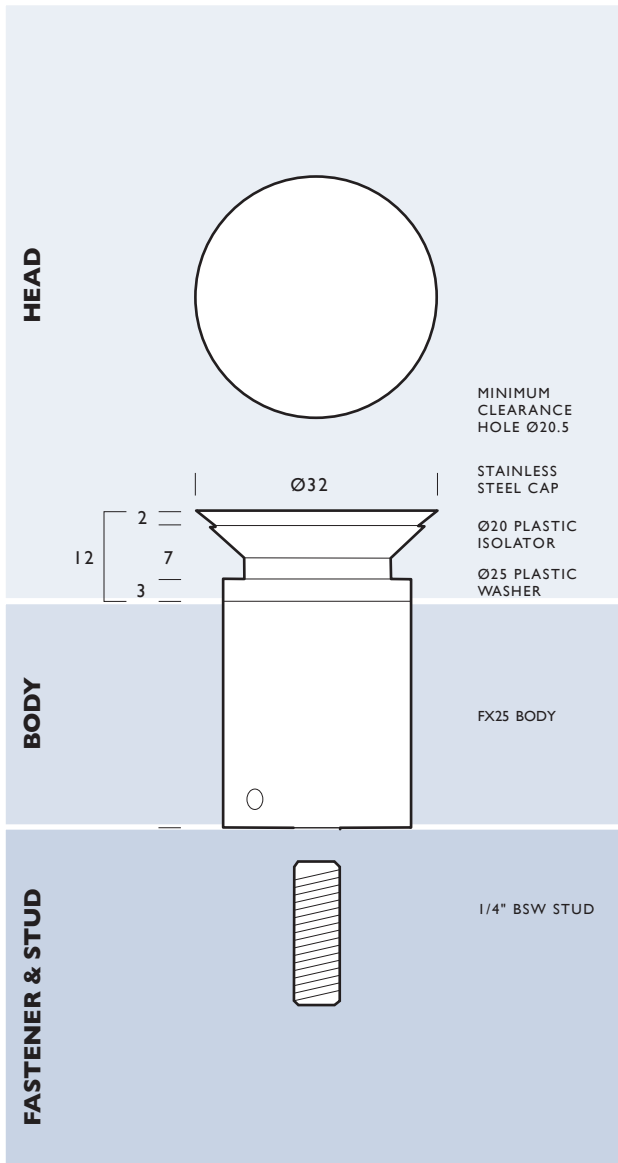

HEAD:
FX32 CSP

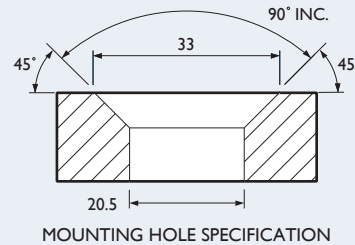
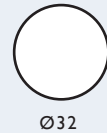

FX32 CSP HEAD PACK:

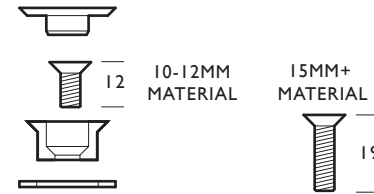

MATERIAL:

316 Grade Stainless Steel

PANEL THICKNESS:

Head Pack 10 - 15mm

Optional 1/4" B.S.W countersunk machine screw available:

12mm, 19mm, 25mm, 32mm, 38mm, 44mm, 50mm, 75mm

MINIMUM CLEARANCE HOLE:

The clearance hole is 20.5mm, which is then countersunk to 33mm (refer to diagram).

THREAD:

1/4" B.S.W countersunk machine screw
Fastener: 1/4" B.S.W

FINISH:

Satin Stainless Steel

LOCATION:

Interior & exterior applications

PRODUCT COMPLIANCY:

As FIX Systems are not certified engineers, it is the buyer's responsibility to ensure that the application of all FIX products is suitable for its intended use and that it is compliant with relevant safety standards.

BODIES:

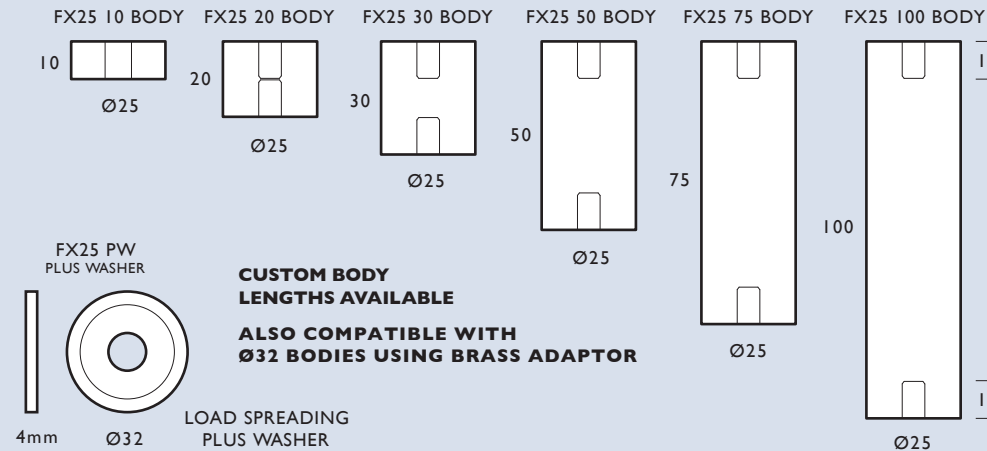

FASTENER: FASTENERS SUPPLIED WITH 1/4" BSW STUD

